



# LEAKPROOF CONNECTIONS

Reporting the news, progress and other happenings at CPV Manufacturing, Inc.

Summer 2002

**When it comes  
to line flushing...  
CPV is "Plug Beautiful."**



If one section of a piping system needs to be altered, cleaned or flushed, CPV O-Seal Flush Plugs can be used to protect the rest of a system from contamination. Simply remove the valve cartridge and insert the appropriate Flush Plugs into the O-Seal valve bodies at either end of the affected area and the rest of the system will be totally cut off from the cleaning or flushing process.

There are three types of flush plugs available: *Under-Seat*, *Over-Seat*, and *Flow-thru*. As can be seen in the schematic drawings, the *Over-Seat* and *Under-Seat* have threaded connections in the top of the plug for trouble-free connection to the flushing pump.

The *Flow-Thru* Plugs are intended for insertion in valves located in the middle of the section being flushed or cleaned. Once installed, these plugs allow the flush to flow through without contaminating the O-Seal valve cartridges. When these valve bodies are equipped with O-Seal Flush Plugs, future system expansion or section flushing is not only easy ... *it's plug beautiful.*



*The CPV O-Seal Flush Plug on the left is the "Flow-Thru-190" which enables the flush to pass from one section of the system to another. The plug in the middle is the "Over Seat-192", and the plug on the right is the "Under Seat-191". These plugs have threaded openings on the top for the entrance/exit of the flush/cleaning fluid.*

**Flush Plug, Under Seat – 191**

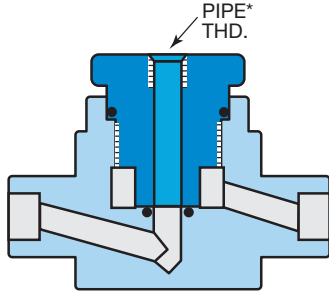

**Flush Plug, Over Seat – 192**

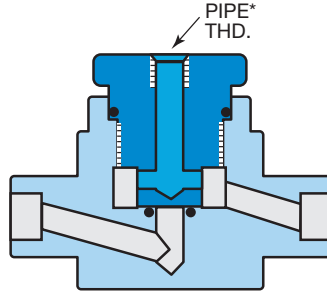

**Flow-Thru Plug – 190**

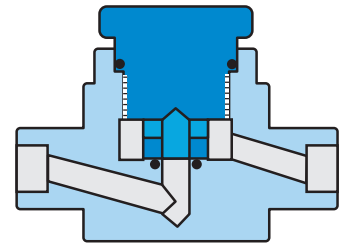

\* 1/8-in. (-0) and 1/4-in. (-1) Flush Plugs – 3/8-in. Taper Pipe Thread. All other sizes – 1/2-in. Taper Pipe Thread

**Over Seat – 192**

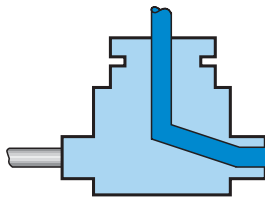

**Flow-Thru – 190**

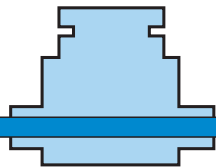

**Under Seat – 191**

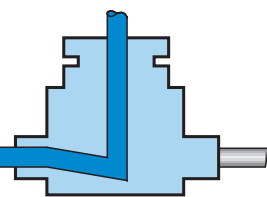

*CPV's O-Seal Flush Plugs isolate the system section to be flushed or cleaned, leaving the rest of the system uncontaminated.*

## CPV – More than just valves & fittings

As you know, CPV manufactures a wide array of valves and fittings for liquid and gas applications. Our products offer absolute reliability and leakproof connections to 6000 psi. In addition to our basic product lines, we offer several product lines that assist our customers with special operations. O-Seal Flush Plugs are one example of these valuable ancillary product lines

In one previous issue of Leakproof Connections we covered O-Seal Valve Spacers which replace O-Seal valves during welding and brazing to protect the valves and seals from excess heat. In another we covered the CPV Stem Seal Installation Tool. By simultaneously compressing

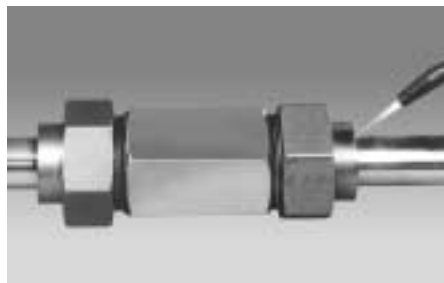

*CPV Valve Spacers are the exact face-to-face dimension of CPV O-Seal valves. They can be used to protect valves during installation, and can be reused again and again for maintenance operations.*

the outer sealing lip and expanding the inner lip of the seal during installation, this tool prevents damage to sealing edges and makes stem seal replacement, fast and easy.

CPV has been a leading manufacturer of valves and fittings since 1915. The company's innovative designs are suited to a wide variety of liquid and gas applications. For technical literature or information on ordering O-Seal Flush Plugs contact:

**Charles J. Horter**  
Sales and Marketing Manager  
CPV Manufacturing, Inc.  
851 Preston Street,  
Philadelphia, PA 19104-1598  
Phone: (215) 386-6508, ext.244  
Toll free: (888) 386-2211  
Fax: (215) 387-9043  
Website: [www.cpvvmfg.com](http://www.cpvvmfg.com)



Since 1915

### CPV Manufacturing, Inc.

851 Preston St., Philadelphia, PA 19104-1598 Phone: (215) 386-6508 Toll free: (888) 386-2211  
Fax: (215) 387-9043 Website: [www.cpvvmfg.com](http://www.cpvvmfg.com)