



Product Category

Part Description

H867-16-10-S

Direct Weld/Braze Insert (Male Tube X Tube SW)

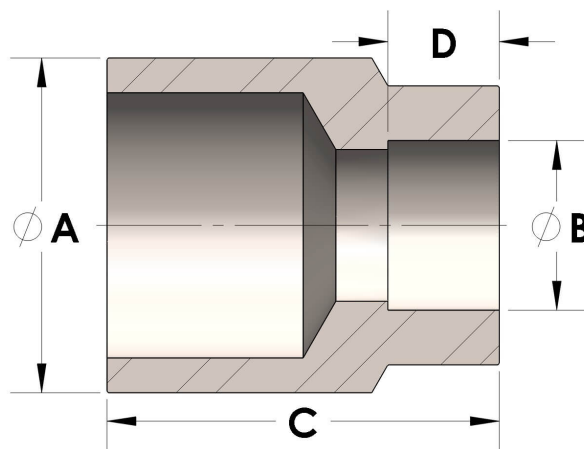

## DIMENSIONS

|   |       |
|---|-------|
| A | 1.000 |
| B | 0.63  |
| C | 1.06  |
| D | 0.380 |

## GENERAL

|                  |                         |
|------------------|-------------------------|
| Pressure Rating  | 3000 PSI                |
| Fitting Material | Carbon Steel, ASTM A108 |

The complete catalog contents must be reviewed to ensure that the system designer and user make a safe product selection. When selecting products, the total system design must be considered to ensure safe, trouble-free performance. Function, material compatibility, adequate ratings, proper installation, operation, and maintenance are the responsibilities of the system designer and user. Caution: Do not mix or interchange valve components with those of other manufacturers.