

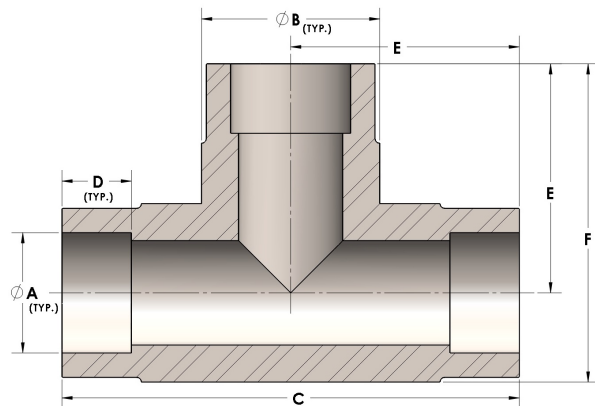

**Product Category**  
**Part Description**

H830-24-CUNI  
Direct Socketweld/Braze Tee (Tube)



## DIMENSIONS

A	1.500
B	1.88
C	4.38
D	0.630
E	2.19
F	3.13

## GENERAL

Pressure Rating	2000 PSI
Fitting Material	Copper Nickel 70/30, MIL-C--15726F, UNS C71500