



Product Category

Part Description

H830-32-M

Direct Socketweld/Braze Tee (Tube)

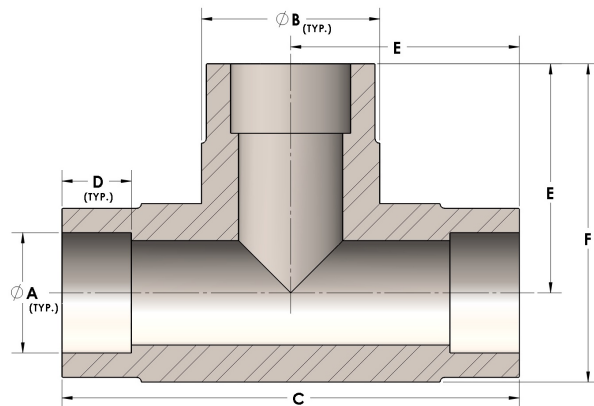

DIMENSIONS

A	2.000
B	2.75
C	5.75
D	0.880
E	2.88
F	4.25

GENERAL

Pressure Rating	6000 PSI
Fitting Material	Monel®, ASTM B164, UNS N04405