



Product Category

Part Description

H830-10-S

Direct Socketweld/Braze Tee (Tube)

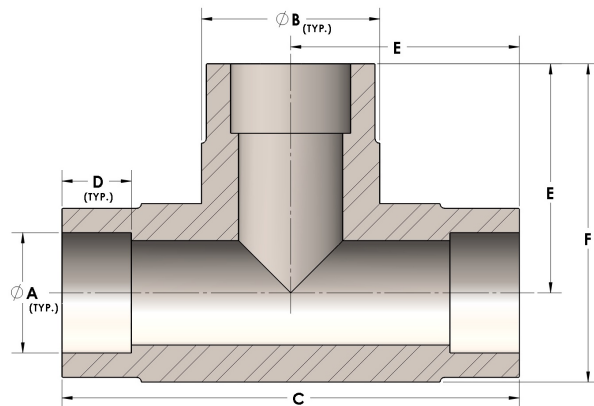

## DIMENSIONS

A	0.630
B	0.88
C	2.38
D	0.380
E	1.19
F	1.63

## GENERAL

Pressure Rating	4500 PSI
Fitting Material	Carbon Steel, ASTM A108