



Product Category

Part Description

H830-16-S

Direct Socketweld/Braze Tee (Tube)

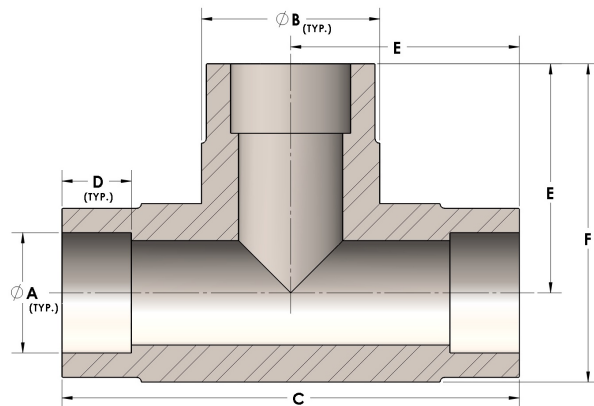

## DIMENSIONS

A	1.000
B	1.38
C	3.13
D	0.500
E	1.56
F	2.25

## GENERAL

Pressure Rating	4500 PSI
Fitting Material	Carbon Steel, ASTM A108