

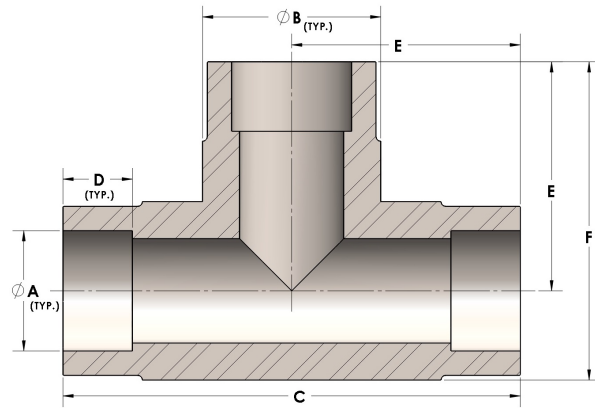

**Product Category**  
**Part Description**

H830-06-CUNI  
Direct Socketweld/Braze Tee (Tube)



## DIMENSIONS

A	0.380
B	0.63
C	1.63
D	0.250
E	0.81
F	1.13

## GENERAL

Pressure Rating	3000 PSI
Fitting Material	Copper Nickel 70/30, MIL-C--15726F, UNS C71500