

**Product Category**

10D-C-SS-R

**Product Line**

Cast Iron & Bronze Flanged Check Valves (10D, 11D, 12D, 13D, 20D, 21D)

**Part Description**

CLASS 125 Flange Style Silent Check Valve with Cast Iron Body and Stainless Steel Trim

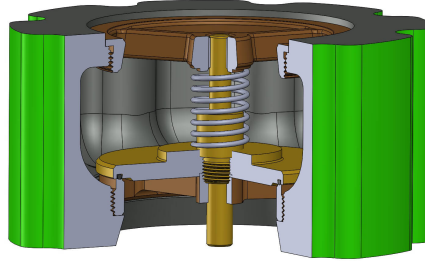

## DIMENSIONS

Face to Face	3.13
Dia. of Bolt Circle	6.00
Dia. of Flange	7.50
No. of Studs	4
Dia. of Studs	0.63
Length of Studs	7.50
Weight (lbs.)	15

## GENERAL

Pressure Rating	up to 200 PSI
Temperature Range	-30°F to 250°F (-34°C to 121°C)
Standard Soft Goods	Buna-N O-Rings
Cartridge Type	Check
Connection Type	ANSI B16.5 Flange
Connection Size	3"
Body Material	Cast Iron, ASTM A126, CL. B



## OPTIONS

**Port & Vent Options**

[-DP] Drain Plug Above Seat (1/2" NPT)

**Optional Soft Goods**

Viton® O-Rings, EPDM O-Rings