



Product Category

11D-F-SS-R

Product Line

Cast Iron & Bronze Flanged Check Valves (10D, 11D, 12D, 13D, 20D, 21D)

Part Description

CLASS 250 Flange Style Silent Check Valve with Cast Iron Body and Stainless Steel Trim

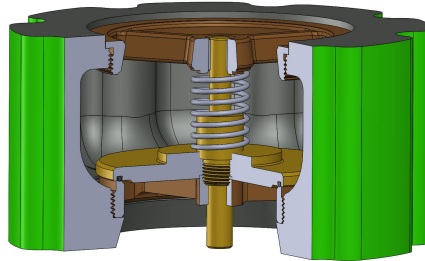

DIMENSIONS

Face to Face	5.5
Dia. of Bolt Circle	10.63
Dia. of Flange	12.50
No. of Studs	12
Dia. of Studs	0.75
Length of Studs	11.50
Weight (lbs.)	75

GENERAL

Pressure Rating	up to 500 PSI
Temperature Range	-30°F to 250°F (-34°C to 121°C)
Standard Soft Goods	Buna-N O-Rings
Cartridge Type	Check
Connection Type	ANSI B16.5 Flange
Connection Size	6"
Body Material	Cast Iron, ASTM A126, CL. B



OPTIONS

Port & Vent Options	[-DP] Drain Plug Above Seat (3/4" NPT)
Optional Soft Goods	Viton® O-Rings, EPDM O-Rings