



Product Category

13D-B-B-R

Product Line

Cast Iron & Bronze Flanged Check Valves (10D, 11D, 12D, 13D, 20D, 21D)

Part Description

CLASS 300 Flange Style Silent Check Valve with Bronze Body and Bronze Trim

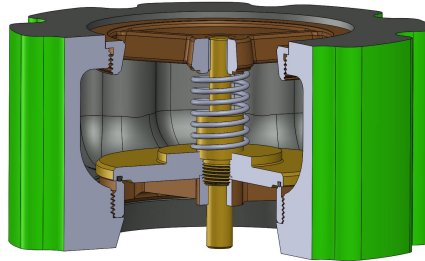

## DIMENSIONS

Face to Face	2.88
Dia. of Bolt Circle	5.88
Dia. of Flange	7.50
No. of Studs	8
Dia. of Studs	0.75
Length of Studs	7.00
Weight (lbs.)	13

## GENERAL

Pressure Rating	up to 750 PSI
Temperature Range	-30°F to 250°F (-34°C to 121°C)
Standard Soft Goods	Buna-N O-Rings
Cartridge Type	Check
Connection Type	ANSI B16.5 Flange
Connection Size	2.5"
Body Material	Valve Bronze, ASTM B61, UNS C92200



## OPTIONS

**Port & Vent Options**

[-DP] Drain Plug Above Seat (3/8" NPT)

**Optional Soft Goods**

Viton® O-Rings, EPDM O-Rings