



Product Category

13D-F-B-R

Product Line

Cast Iron & Bronze Flanged Check Valves (10D, 11D, 12D, 13D, 20D, 21D)

Part Description

CLASS 300 Flange Style Silent Check Valve with Bronze Body and Bronze Trim

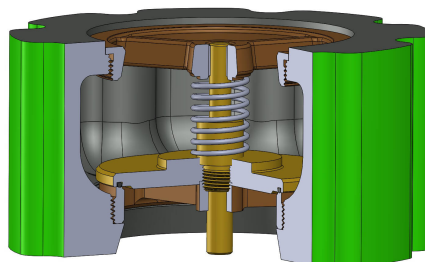

DIMENSIONS

Face to Face	5.5
Dia. of Bolt Circle	10.63
Dia. of Flange	12.50
No. of Studs	12
Dia. of Studs	0.75
Length of Studs	11.50
Weight (lbs.)	86

GENERAL

Pressure Rating	up to 750 PSI
Temperature Range	-30°F to 250°F (-34°C to 121°C)
Standard Soft Goods	Buna-N O-Rings
Cartridge Type	Check
Connection Type	ANSI B16.5 Flange
Connection Size	6"
Body Material	Valve Bronze, ASTM B61, UNS C92200



OPTIONS

Port & Vent Options

[-DP] Drain Plug Above Seat (3/4" NPT)

Optional Soft Goods

Viton® O-Rings, EPDM O-Rings