

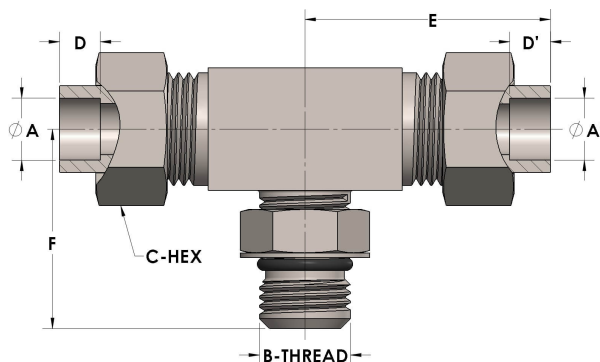

**Product Category**  
**Part Description**

H815-20-20-20-M  
Tube to Male Straight Thread Branch Tee Assembly



## DIMENSIONS

A	1.250
A"	1.250
B-THREAD	1.625" - 12UN
C-HEX	2
D	0.560
D"	0.560
E	3.06
F	2.25

## GENERAL

Pressure Rating	4500 PSI
Tailpiece Material	Monel®, ASTM B164, UNS N04405
Threadpiece Material	Monel®, ASTM B564, UNS N04400
O-Ring Material	Viton® Fluorocarbon Type 1, Class 2 (90 durometer)
Connection 1 Type	Female Tube Socket
Connection 1 Size	1.25" Tube O.D. (-20)
Connection 2 Type	Female Tube Socket