

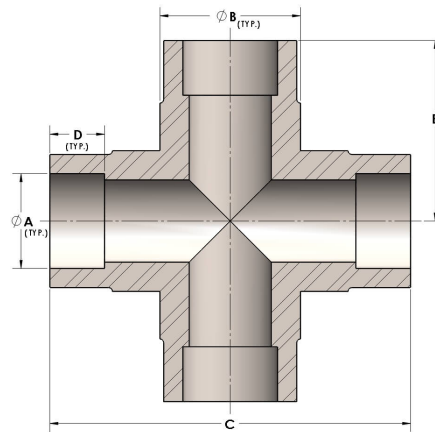

Product Category  
Part Description

H819-10-SS316L  
Direct Socketweld/Braze Cross (Tube)



## DIMENSIONS

A	0.630
B	0.88
C	2.38
D	0.380
E	1.19
F	1.63

## GENERAL

Pressure Rating	4500 PSI
Fitting Material	316/L Stainless Steel, ASTM A276, UNS S31600/03