

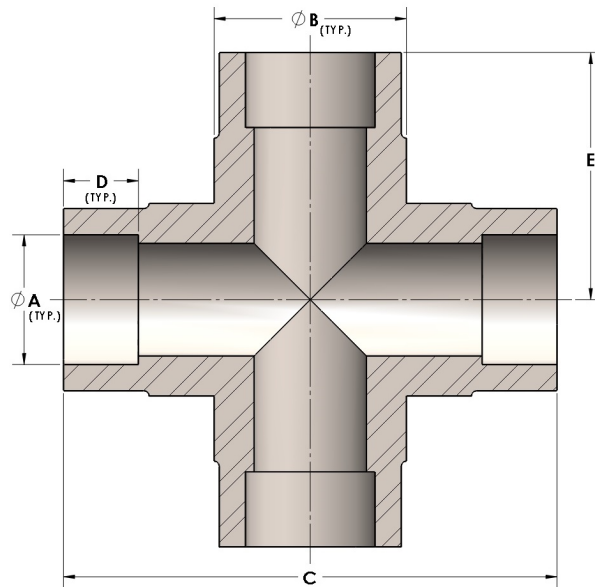

**Product Category**  
**Part Description**

H819-20-SS316L  
Direct Socketweld/Braze Cross (Tube)



## DIMENSIONS

A	1.250
B	1.63
C	3.88
D	0.560
E	1.94
F	2.75

## GENERAL

Pressure Rating	3000 PSI
Fitting Material	316/L Stainless Steel, ASTM A276, UNS S31600/03