

Product Category

H823-20-20-S

Part Description

Tube to Male Straight Thread Elbow Assembly

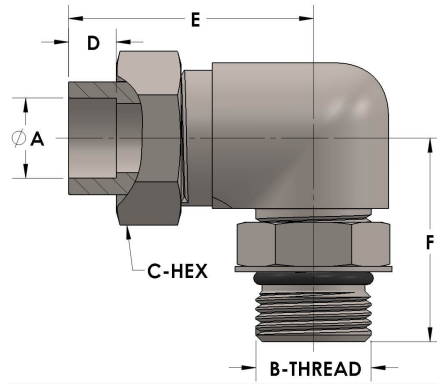

DIMENSIONS

A	1.250
B-THREAD	1.625" - 12UN
C-HEX	2
D	0.560
E	3.06
F	2.25

GENERAL

Pressure Rating	3000 PSI
Assembly Material	Carbon Steel, ASTM A108
O-Ring Material	Viton® Fluorocarbon Type 1, Class 2 (90 durometer)
Connection 1 Type	Female Tube Socket
Connection 1 Size	1.25" Tube O.D. (-20)
Connection 2 Type	Male Straight Thread
Connection 2 Size	1.625" - 12UN (-20)