



Product Category

Part Description

H823-20-20-SS316L

Tube to Male Straight Thread Elbow Assembly

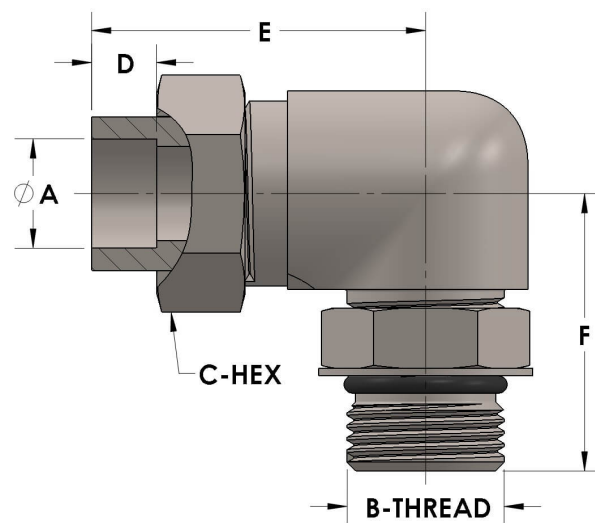

## DIMENSIONS

A	
B-THREAD	1.625" - 12UN
C-HEX	2
D	
E	
F	

## GENERAL

Pressure Rating	3000 PSI
Assembly Material	316/L Stainless Steel, ASTM A276, UNS S31600/03
O-Ring Material	Viton® Fluorocarbon Type 1, Class 2 (90 durometer)
Connection 1 Type	Female Tube Socket
Connection 1 Size	1.25" Tube O.D. (-20)
Connection 2 Type	Male Straight Thread
Connection 2 Size	1.625" - 12UN (-20)