



Product Category

H830-04-SS316L

Part Description

Direct Socketweld/Braze Tee (Tube)

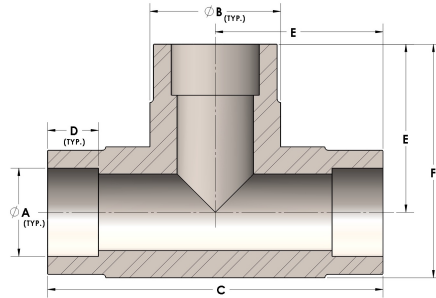

DIMENSIONS

| | |
|---|-------|
| A | 0.250 |
| B | 0.63 |
| C | 1.63 |
| D | 0.190 |
| E | 0.81 |
| F | 1.13 |

GENERAL

| | |
|------------------|---|
| Pressure Rating | 6000 PSI |
| Fitting Material | 316/L Stainless Steel, ASTM A276, UNS S31600/03 |