

Product Category

H840-04-S

Part Description

Direct Socketweld/Braze 90° Elbow (Tube)

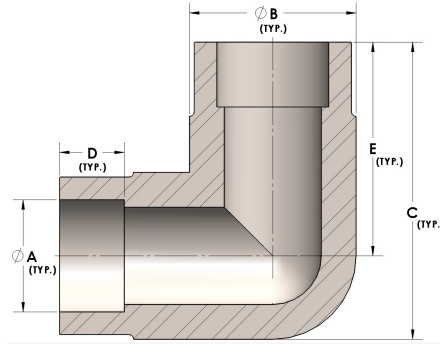

DIMENSIONS

| | |
|---|-------|
| A | 0.250 |
| B | 0.63 |
| C | 1.13 |
| D | 0.190 |
| E | 0.81 |

GENERAL

| | |
|------------------|-------------------------|
| Pressure Rating | 6000 PSI |
| Fitting Material | Carbon Steel, ASTM A108 |