

Product Category

H840-12-CUNI

Part Description

Direct Socketweld/Braze 90° Elbow (Tube)

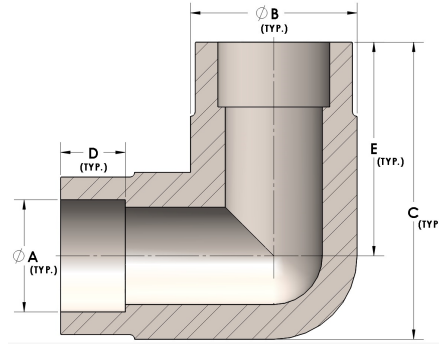

## DIMENSIONS

<b>A</b>	0.750
<b>B</b>	1.13
<b>C</b>	2.00
<b>D</b>	0.440
<b>E</b>	1.44

## GENERAL

<b>Pressure Rating</b>	3000 PSI
<b>Fitting Material</b>	Copper Nickel 70/30, MIL-C--15726F, UNS C71500