



Product Category

Part Description

H849-32-M

Socketweld/braze Tube Union Assembly

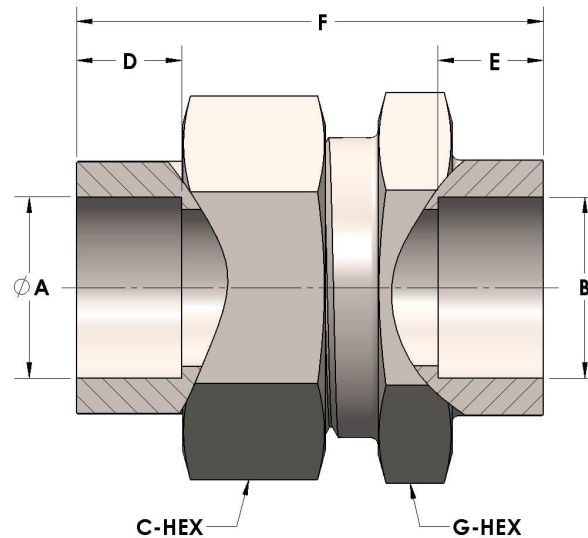

DIMENSIONS

| | |
|-------|-------|
| A | 2.000 |
| B | 2.00 |
| C-HEX | 3.25 |
| D | 0.880 |
| E | 0.88 |
| F | 3.19 |
| G-HEX | 3 |

GENERAL

| | |
|-------------------|--|
| Pressure Rating | 6000 PSI |
| Assembly Material | Monel®, ASTM B164, UNS N04405 |
| O-Ring Material | Viton® Fluorocarbon Type 1, Class 2 (90 durometer) |
| Connection 1 Type | Female Tube Socket |
| Connection 2 Type | Female Tube Socket |

cpvmfg.com | 484.731.4010

The complete catalog contents must be reviewed to ensure that the system designer and user make a safe product selection. When selecting products, the total system design must be considered to ensure safe, trouble-free performance. Function, material compatibility, adequate ratings, proper installation, operation, and maintenance are the responsibilities of the system designer and user. Caution: Do not mix or interchange valve components with those of other manufacturers.