



Product Category

Part Description

H867-20-04-S

Direct Weld/Braze Insert (Male Tube X Tube SW)

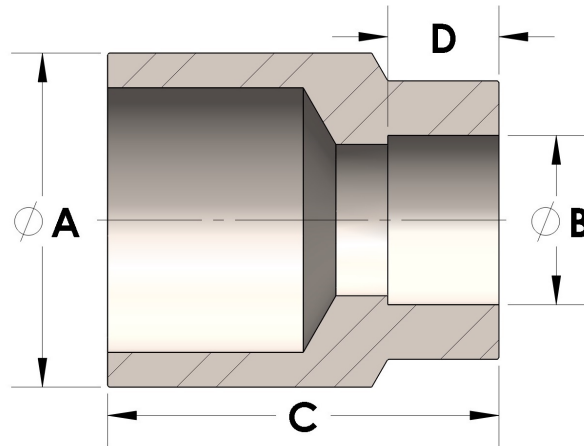

DIMENSIONS

| | |
|---|-------|
| A | 1.250 |
| B | 0.25 |
| C | 1.25 |
| D | 0.190 |

GENERAL

| | |
|------------------|-------------------------|
| Pressure Rating | 4500 PSI |
| Fitting Material | Carbon Steel, ASTM A108 |

The complete catalog contents must be reviewed to ensure that the system designer and user make a safe product selection. When selecting products, the total system design must be considered to ensure safe, trouble-free performance. Function, material compatibility, adequate ratings, proper installation, operation, and maintenance are the responsibilities of the system designer and user. Caution: Do not mix or interchange valve components with those of other manufacturers.