

Product Category

126D-C-B-R

Product Line

Air Check Valves (14D, 15D, 16D, 17D, 125D, 126D)

Part Description

CLASS 300 Flange Style Silent Air Check Valve with Steel Body and Bronze Trim

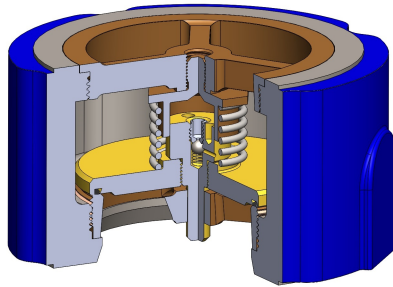

DIMENSIONS

| | |
|---------------------|------|
| Face to Face | 3.13 |
| Dia. of Bolt Circle | 6.63 |
| Dia. of Flange | 8.25 |
| No. of Studs | 8 |
| Dia. of Studs | 0.75 |
| Length of Studs | 8.5 |
| Weight (lbs.) | 15 |

GENERAL

| | |
|---------------------|------------------------------------------|
| Pressure Rating | 300 PSI |
| Temperature Range | -30°F to 250°F (-34°C to 121°C) |
| Standard Soft Goods | Buna-N O-Rings |
| Cartridge Type | Air Check |
| Connection Type | ANSI B16.5 Flange |
| Connection Size | 3" |
| Body Material | Carbon Steel, ASTM A216, WCB, UNS J03002 |

OPTIONS

| | |
|--------------------------|----------------------------------------|
| [-P] Port & Vent Options | [-DP] Drain Plug Above Seat (1/2" NPT) |
| Optional Soft Goods | Viton® O-Rings, EPDM O-Rings |