



Product Category

H830-16-M

Part Description

Direct Socketweld/Braze Tee (Tube)

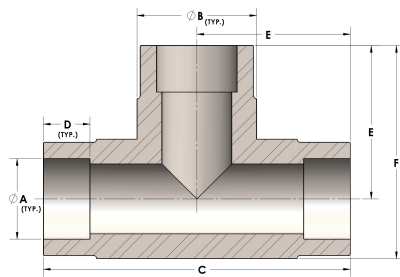

## DIMENSIONS

|   |      |
|---|------|
| A | 1.00 |
| B | 1.38 |
| C | 3.13 |
| D | 0.50 |
| E | 1.56 |
| F | 2.25 |

## GENERAL

|                  |                               |
|------------------|-------------------------------|
| Pressure Rating  | 6000 PSI                      |
| Fitting Material | Monel®, ASTM B164, UNS N04405 |